

Smart mailbox, dedicated and shared lockers, fully controlled via the Mobile App.



Bobnet Mail&Parcel addresses the growing challenges of mail and package reception in multi-unit dwellings, offering a smart, secure, and convenient solution for both residents and property managers. It's not just a mailbox – it's a comprehensive mail and package solution for modern apartment living.

Why Mail&Parcel?

Advanced Technology

- › **Remote Secure Access:** Manage deliveries with our mobile app, generate temporary access codes, scan QR codes, or use a secret PIN key.
- › **Temperature-Controlled Lockers:** Keep perishables fresh with our optional cooling system. (*optional)
- › **Always Connected:** Wi-Fi or 4G enabled for real-time updates & remote management.

Flexibility and Customization

- › **Modular Design:** Our system features four standard modules that can be configured in various ways to fit different parcel sizes and building layouts. These modules connect seamlessly, offering a versatile, plug-and-play solution that adapts to market needs. The standard modules are designed for both indoor and outdoor use.
- › **Branding Opportunities:** Customize the look and feel of the lockers to match the location aesthetic.

Enhanced Security and Convenience

- › **24/7 Access:** Residents and users can retrieve their packages anytime.
- › **Advanced Security Features:** Mobile app button, unique QR and PIN codes for secure access.
- › **Instant Notifications:** Real-time alerts for all activities ensure users are always informed.

Affordable and Convenient

Enjoy all these features with a single, one-time payment. No recurring fees or hidden costs, providing long-term value and peace of mind.

Mail&Parcel Features

- › **Flexible Installation:** Indoor/outdoor options require only power and an internet connection
- › **Smart Interface:** Water and dust-proof touchscreen with a simple user interface
- › **Always Connected:** Wi-Fi or 4G enabled

- › **Built to Last:** Galvanised metal with a 10+ year lifespan
- › **Weather-Resistant:** -15 to +45°C range, frost & rain resistant
- › **Secure Access:** Mobile App/QR code scanning, traditional key
- › **Power Backup:** 4-hour autonomy for uninterrupted service
- › **Temperature Controlled:** Optional cooling system or ventilation system
- › **Power Outage:** During a power outage, the cells can still be accessed using the traditional key.
- › **Modular Design:** Wall-mounted, plug and play, easy expansion or reconfiguration as needed.
- › **For All Users:** Our solution supports both digital and non-digital users. Non-digital users can rely on the traditional key for secure access.
- › **All-in-One Solution:** Combines individual mailboxes with shared delivery cells for all needs.

Mobile App Features

- › **Remote Access:** Control mailbox from anywhere using the app.
- › **Push Notifications:** Instant cell activity alerts.
- › **User-Friendly Interface:** Intuitive design
- › **Digital Key:** Smartphone unlocking through the mobile app.
- › **Cell History:** Log of all cell activity.
- › **Compartment Booking:** Reserve to receive large packages when not at home.
- › **Guest Access:** Temporary codes for others
- › **Multi-Language Support:** On request
- › **Paperless Receipts:** Digital delivery confirmations
- › **Guest Mode:** Access basic functionalities without creating an account.
- › **Internet Outage:** In the event of an internet outage, you can use both the traditional key and the secret PIN code to unlock the door.

How it Works

For the courier

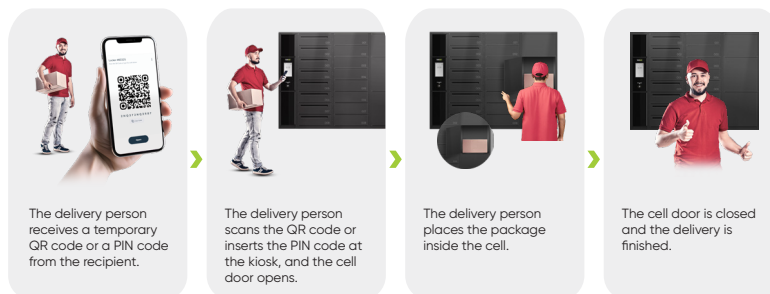

End-user For the tenant

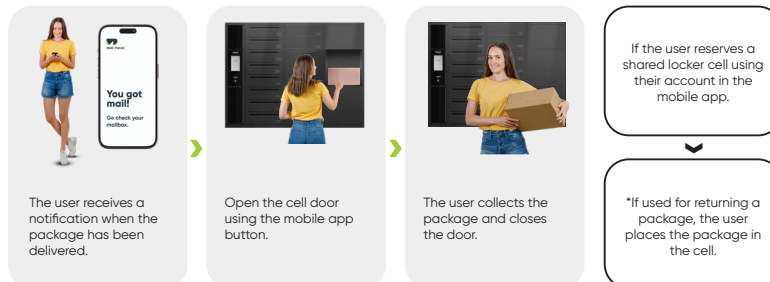

Product Information



Module Dimensions(LxWxH)

1	Command Module	228x326x1147 cm
2	Smart Mailbox	477x326x1147 cm
3	Personal Parcel Box	477x326x1147 cm
4	Shared Locker	477x326x1147 cm

Control Panel

The control panel has a standard size for the entire construction.

- › Water & dust proof touch screen, colour, 7" diagonal, secured glass
- › Mini PC (ARM processor)
- › Barcode and QR scanner/reader
- › Wi-fi or 4G internet connection router
- › Electricity supply system
- › Backup power system with approximately 4 hours of autonomy
- › Ventilation for temperature control.

Minimum requirements for installation

Electricity and internet connection need to be available at the installation point.

Functioning conditions

Temperature: -15 to +45 °
Frost-resistant doors with rain drainage strips
Relative humidity: 5 to 95 %
Wind resistance: max. 0.85 kN/m²
Noise: < 45 dB(A)
Snow load: max. 5 kN/m²

*Alternatively, extend the cell reservation through the mobile App if needed.